

## Ejector Collar Replacement Instructions

### When to replace:

VistaLab Technologies recommends that Ovation pipette's Ejector Collar be replaced if the following symptoms are occurring:

- Ejector Sleeve no longer snaps on

### Replacement Ejector collar Kit includes:

- Replacement Ejector Collar
- Spring Clip Tool

### Replace an Ejector Collar:

1. Remove the plunger thumb button.
2. Using a T6 Torx screwdriver, unscrew and remove the three screws in the top cover  
(Refer to *Figure 1*).



Figure 1: Screws in top cover

3. Gently lift and rotate the top cover and hook so that the entire ejector button is exposed.(Refer to *Figure 2*).



**Figure 2: Top plate and hook rotated**

4. Push the ejector sleeve all of the way inward. Restrain the ejector spring by threading the spring clip tool through the screw holes in the top of the front cover. You may find this easier to do with the pipette lying on its backside (Refer to *Figure 3*).

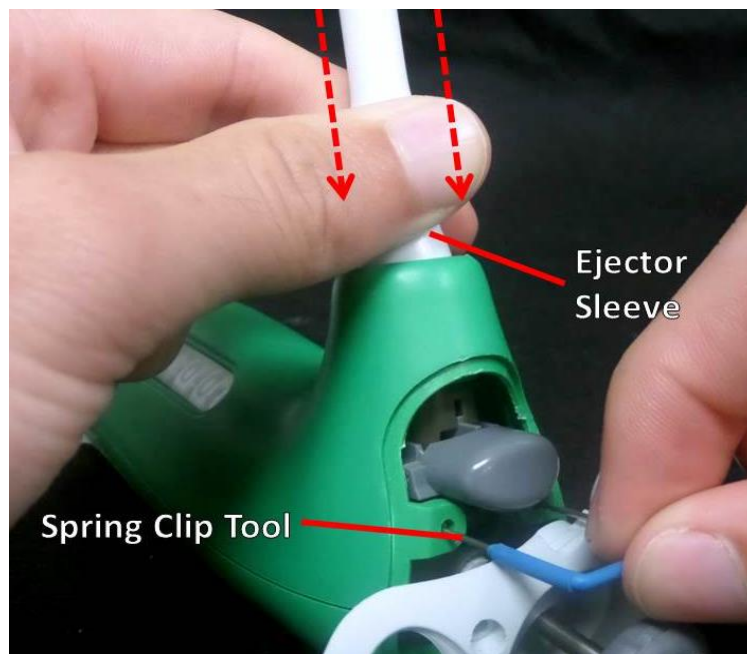

**Figure 3: Inserting spring clip tool to restrain ejector spring**

5. With the ejector sleeve still pushed all of the way in, move the ejector button back and forth repeatedly until it lifts from its current position (Refer to *Figure 4*)



**Figure 4: Ejector sleeve pushed inward, ejector spring restrained**

6. Pull the ejector sleeve outward completely. (Refer to *Figure 4* and *Figure 5*).

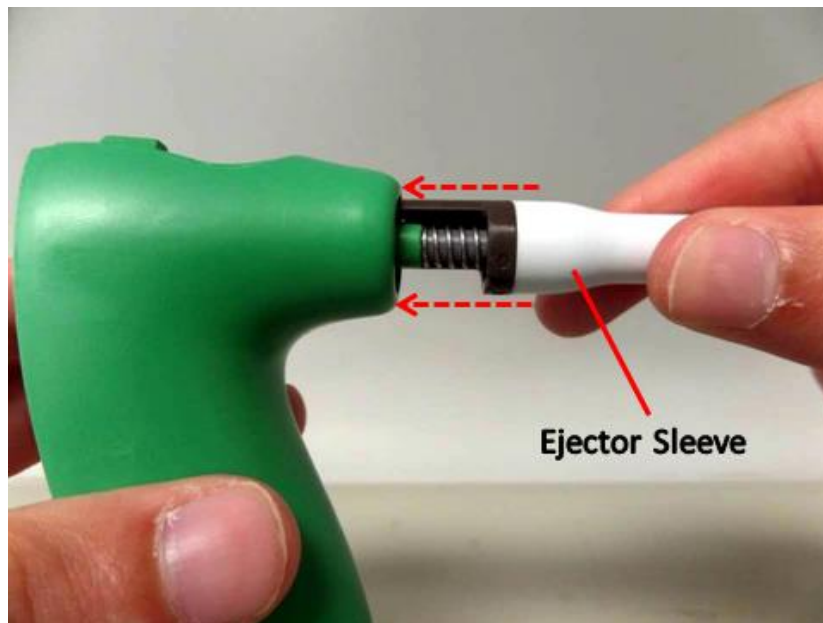

**Figure 5: Removing ejector sleeve and collar**

7. Remove the brown ejector collar from the white ejector sleeve by pulling them apart (Refer to *Figure 6*).

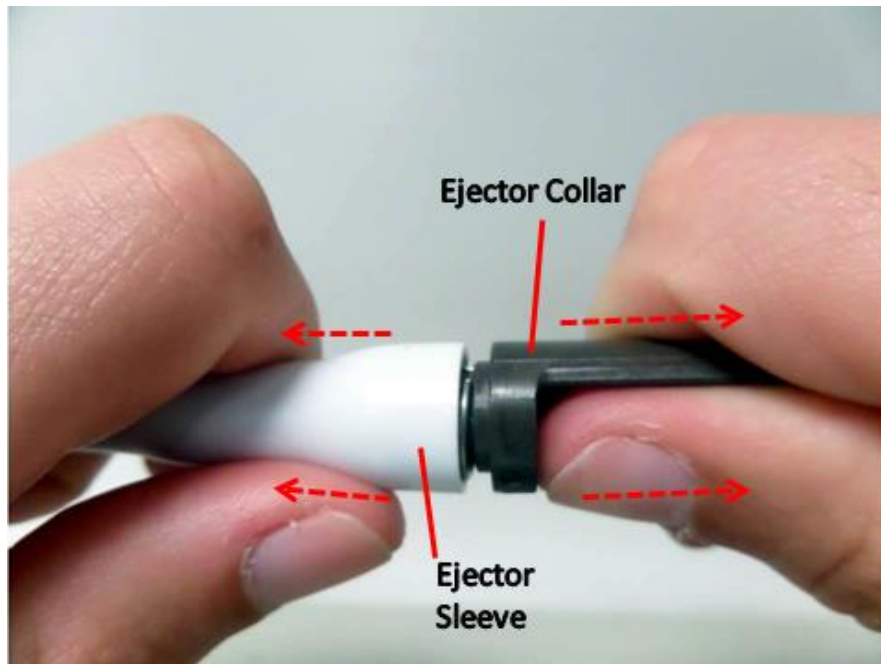

**Figure 6: Removing ejector collar**

8. Attach the new ejector collar provided to the white ejector sleeve. Insert the small cylindrical end of the ejector collar into the larger end of the white ejector sleeve. Push the two pieces together until you hear a “click,” indicating that the two are locked together.

9. Reinsert the ejector sleeve into the housing by first sliding the hole of the ejector collar over the nozzle extension tube. With the tab of the ejector collar facing upwards, push the ejector sleeve into the housing (Refer to *Figure 7*).

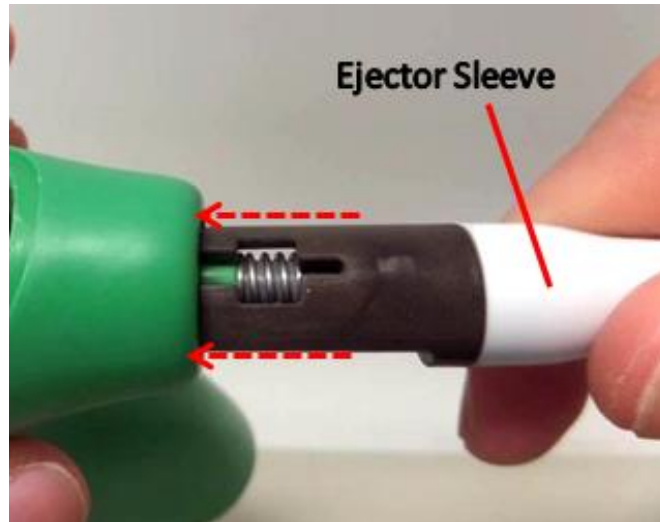

**Figure 7: Inserting ejector sleeve**

10. Slide the ejector sleeve inwards so that the ejector collar fits through the ejector button (Refer to *Figure 8*).



**Figure 8: Ejector collar through ejector button**

11. With the ejector sleeve pushed completely inwards, move the ejector button until the tab fits through the key hole in the ejector collar (Refer to *Figure 9*).

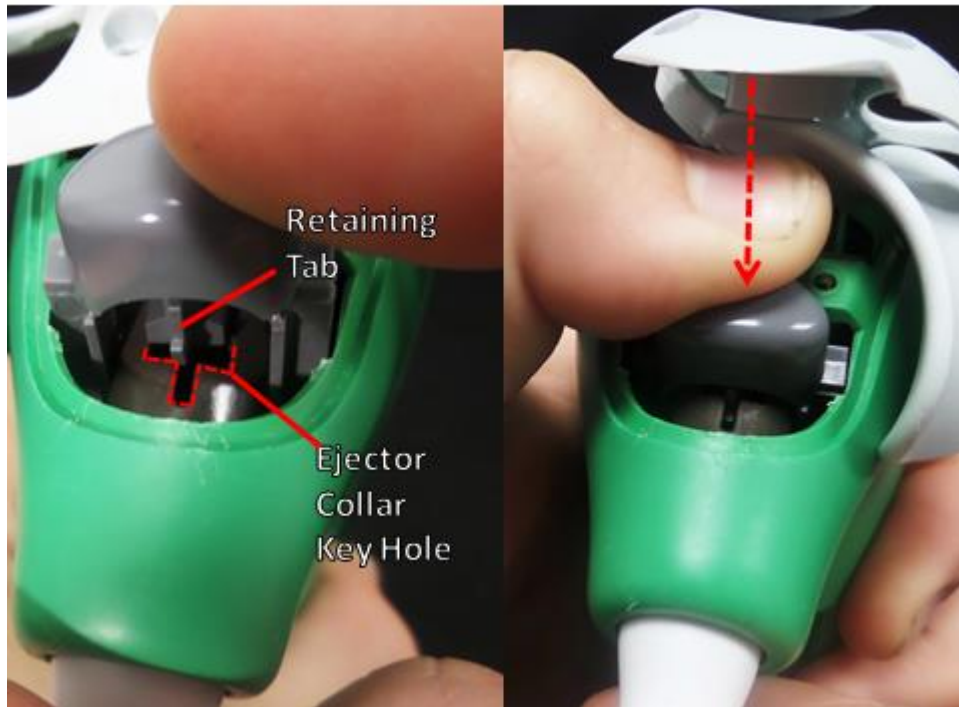

**Figure 4: Ejector button and ejector collar key hole fit**

12. Remove the spring clip tool and reconnect the hook and top cover is necessary
13. Rotate the top cover and hook so that the hole for the ejector button in the top cover fits over the ejector button.
14. Using the T6 Torx screwdriver, drive the three screws into in the top cover until snug to fasten the top cover and hook with the housing. DO NOT over tighten the screws (Refer to *Figure 1*).